

# Cabin Loading Factsheet

## Boeing 777-300ER (77W)

### Available Aircraft-Type

Boeing 777-300ER(77W), Economy Class only

### Flight limitation

Cargo Flights only—inbound and outbound flight

### Commodity limitation

Medical equipment, no dangerous Goods (DG) or liquids allowed, max. 20 kg per parcel

### Summary of Processes

Aircraft needs to be prepared at ZRH before departure and Crew to be enhanced by a loadmaster, Aircraft loading with enhanced local loading team (approx. 30 Persons) under LX Supervision, Cargo has to be supervised during flight

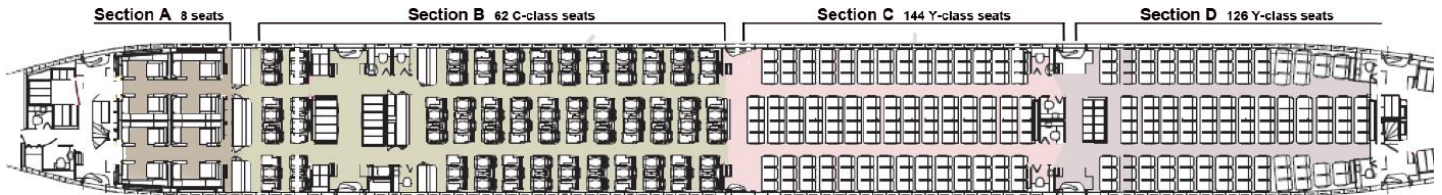

	Available position	Length (cm)	Width (cm)	Height (cm)	est. Volume (m3)	max. Weight
Single seat loading	270	42	54	80	49.0	75kg per seat
Seatloading w/o armrest over 2 seat	108	94	42	80		
Hatrack middle row long	12	130	45	35	2.5	34kg per hatrack
Hatrack middle row short	2	75	45	35	0.2	34kg per hatrack
Hatrack side row long	12	92	45	30	1.5	34kg per hatrack
Hatrack side row short	6	75	45	30	0.6	34kg per hatrack
Below front seat	250*	38	35	18	6.0	20kg per seat
In front of seat	250*	38	25	40	9.5	20kg per seat

\* Some Positions are blocked to tie down nets and straps

More information at [swissworldcargo.com/belly-charter](https://www.swissworldcargo.com/belly-charter)